

## DESCRIPTION AND APPLICATION

The **SP015 Batteries holder** is designed to be used as an accessory for battery powered transducers with radio output to Sigfox net (from Wx8xx series\*). It allows you to power the transducer from one or two 3.6V lithium batteries, size "C", thus extending up to six times the operating time compared to the standard life of size "AA" internal battery. It is equipped with a connection adapter that is mounted in place of the transducer's internal battery. The SP015 Batteries holder is suitable for applications where the life of the transducer's internal battery is insufficient and the mains power supply (with optional accessories) cannot be used.

\*) Applicable to W0810, W0811, W0832, W0850, W3810, W3811, W7810 models.

## SAFETY NOTICE



- use only recommended batteries in the device
- never mix different manufacturers' batteries or new ones with those already in use
- do not short circuit output of the device, the batteries will be destroyed
- always insert batteries with the correct polarity, never with the reversed polarity
- do not exceed the specified operating temperatures
- device contains electronic parts that must be disposed of in accordance with local and currently valid legal conditions

## POWER SUPPLY BATTERIES

SP015 Batteries holder is supplied separately, without batteries. It is designed for primary lithium batteries 3.6V, size "C". We recommend using Tadiran SL2770/S batteries (order code A4206). One or two batteries can be fitted. If you choose to use two batteries, always use batteries the same type and manufacturer, origin from same delivery, ie. same age. Always use new, unused batteries. It is forbidden to combine batteries from different manufacturers or to mix new batteries with those already in use.

Battery life values table for operating temperatures up to + 35 ° C:

sending interval:	10 min	20 min	30 min	1 h	3 h	6 h	12 h	24 h
1 pc battery	1 year	2 years	3 years	5 years	10 years	> 10	> 10	> 10
2 pc batteries	2 years	4 years	6 years	10 years	> 10	> 10	> 10	> 10

Use two batteries only in applications where the transducer will be set to shorter sending intervals (from 10 min to 1 h). For long sending intervals (3 h or longer), you can achieve a life of 10 years or more at normal operating temperatures, even with one battery. Battery life of more than 10 years is rather theoretical, because at such a long time the effect of batteries self-discharge may be higher than the power consumption of the device.

At continuous operating temperatures above 35 °C, the battery life may drop by a third or half. In accordance with the transducer manual, the battery life values apply when extraordinary alarm messages are not used or only exceptionally.

## PUTTING DEVICE INTO OPERATION

### 1) Mounting the connection adapter on the transducer

- unscrew the four screws at the corners of the transducer case and remove the cover
- if you have a new transducer, install it according to the transducer manual (keep it working from the supplied battery). After the adapter is mounted, the *Configuration* button inside the device will not be accessible - therefore, before continuing, make sure that the device is turned on and that you do not require accelerated transducer parameter settings.
- remove the battery by pulling on its handle from the ready transducer
- insert one SP015 connection adapter contact into the Wx8xx transducer battery contact field. Then insert the second contact into the other the transducer battery contact field and close the cover. The contacts of the two devices must fit exactly together.
- verify that the connection adapter is flush with the transducer housing circuit. If not, remove the adapter and repeat the assembly procedure. Under no circumstances should you attempt to force the adapter and transducer into the correct position.
- if the adapter is in the correct position, screw it with the original screws
- keep the original cover and battery for case the adapter is will removed

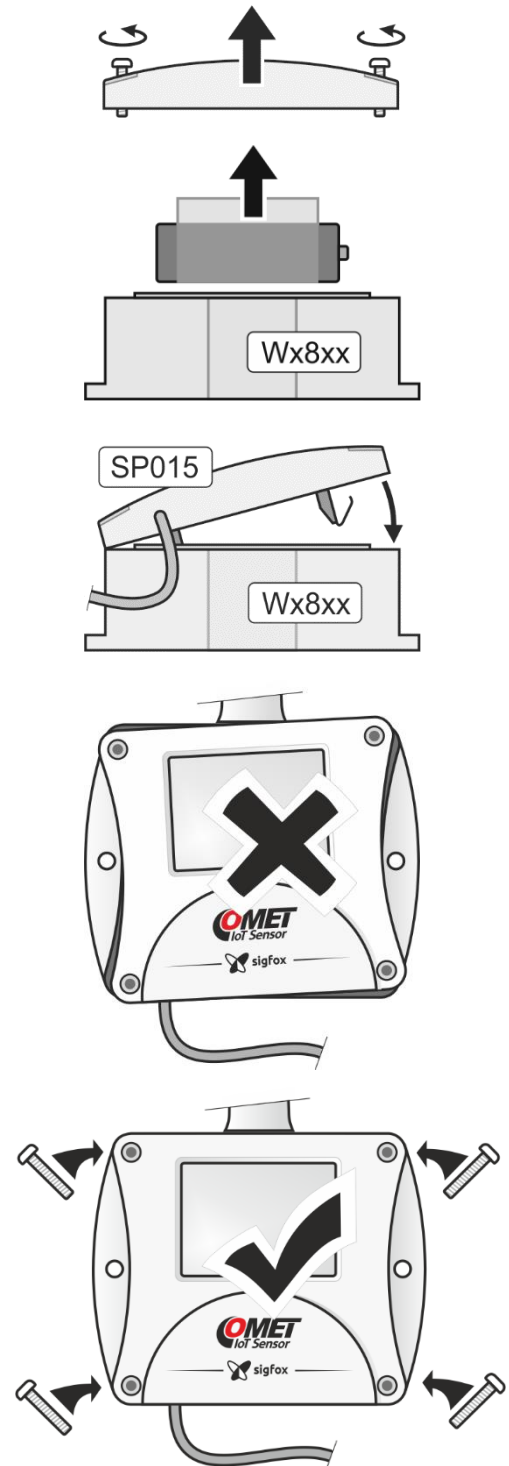

## 2) Battery installation

- unscrew the four screws at the corners of the Batteries holder case and remove the cover
- depending on the required life (see table above), insert into the Batteries holder one or two a 3.6V lithium batteries (of the same type and manufacturer) **with polarity as shown on figure**. Push the battery against the spring of negative contact and then release it. Display of the transducer must light up within 10 seconds and the transducer will start working.
- screw the batteries holder cover. Make sure that the contact surfaces of gasket are free of dirt.

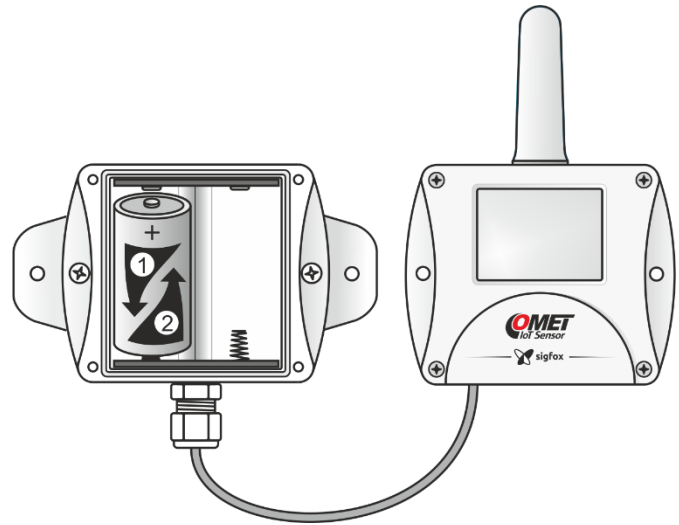

## 3) Assembly and fixing of the assembly

- screw the transducer onto the holder posts (1) with the supplied M4 screws
- screw all the assembly on the selected measuring place (2). Observe the installation instructions and location rules in the transducer manual. Depending on the type of material on which the entire assembly will be mounted, use two suitable 4 mm diameter screws.
- if, for space reasons, it is preferable to arrange both devices side by side, remove the metal posts and montage plate from the batteries holder and screw the holder to the left side of the intended transducer position. Depending on the type of material on which the entire assembly will be mounted, use four suitable 4 mm diameter screws.

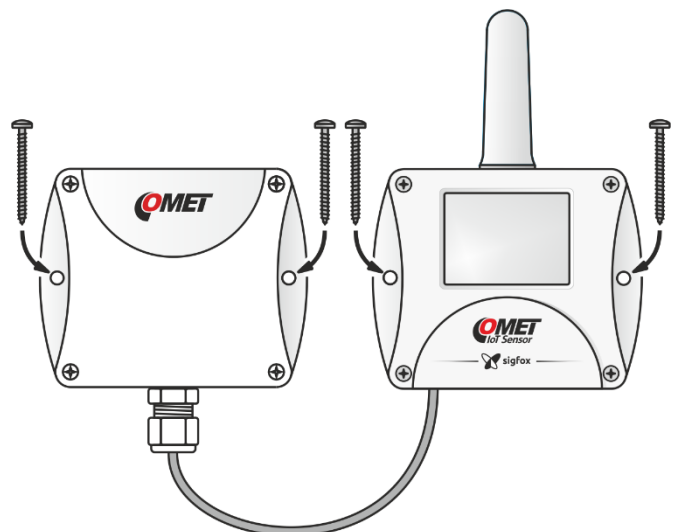
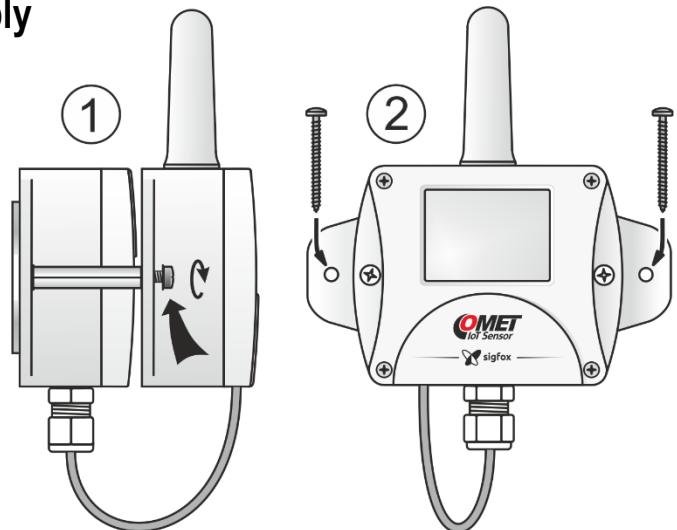

## BATTERY REPLACEMENT

If it is necessary to replace the batteries in the Batteries holder directly at the installation site, first unscrew the transducer from the holder posts (2 M4 screws) and move it to the right of the Batteries holder. Temporarily attach the transducer with only one screw to the right post of the Batteries holder as shown. Do not let the transducer hang by the power cord. Remove the four screws at the corners of case the Batteries holder and remove the cover. Replace the batteries with new ones and reassemble all the assembly in reverse.

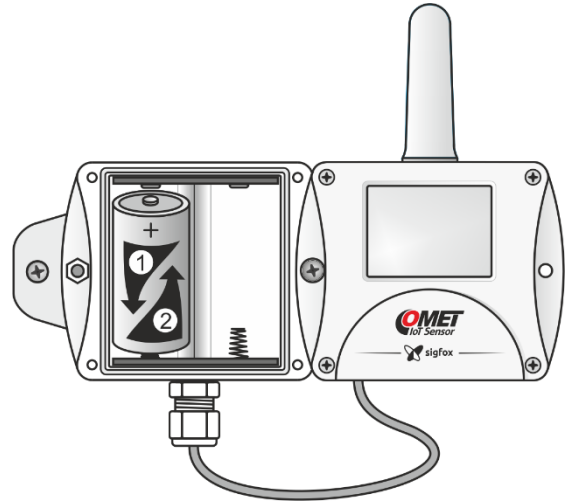

## TECHNICAL PARAMETERS

- recommended batteries: Tadiran SL2770/S, lithium, 3.6 V, size "C"
- output voltage: 3.6 V DC
- continuous output current: max. 200 mA
- short circuit protection of output: no (recommended batteries are not dangerous in the event of a short circuit)
- power output: connection adapter for transducers Wx8xx
- working position: vertically, cable gland down
- IP class: IP65 (after mounting the connection adapter to the Wx8xx sensor)
- operating temperature: -30 to +60 °C
- weight without batteries: 200 g (including connection adapter)
- maximum dimensions: 120 x 93 x 43 mm

## DEVICE DIMENSIONS

